

New Design:

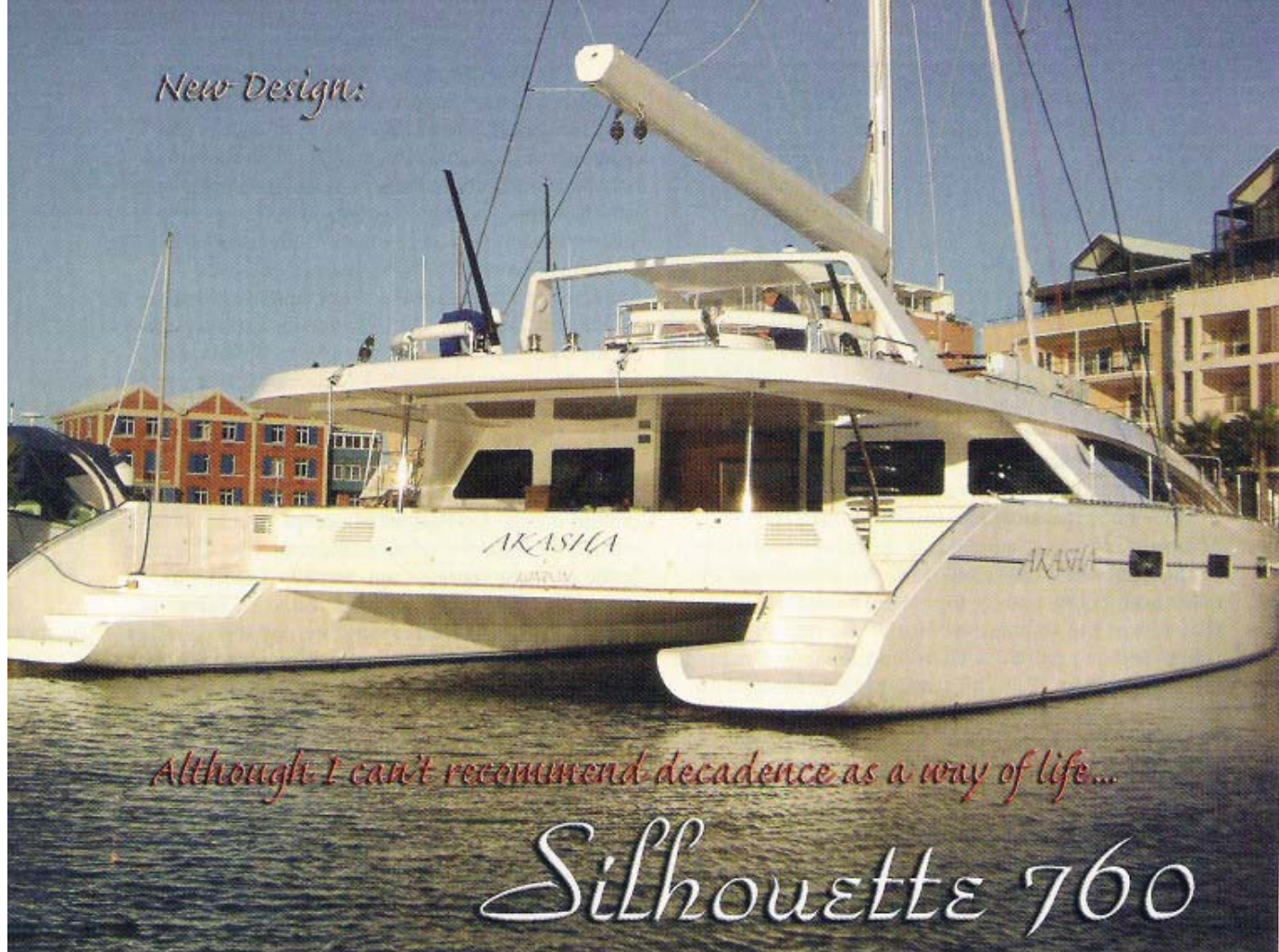

Although I can't recommend decadence as a way of life...

Silhouette 760

Okay, for most of us this can only go on the "wish list" for when we win the lottery, but it's fun to check out anyway. The new innovative Silhouette 760 is the largest catamaran built in South Africa and has really caused a stir in the Luxury yacht market. Built by Matrix Yachts of Cape Town, she was conceived with the distinctive high end market in mind, having the timeless styling of an Italian motor yacht and the performance of a high speed racer. Spacious hulls coupled with an exquisite interior of fine woods and furnishings give a sense of space and opulence which historically have only been reserved for luxurious motor yachts.

This is a thoroughbred yacht with unmatched performance. Built to strict M.C.A. code using the very latest in technology, she has been designed with performance, safety and comfort in mind. On the first test sail she achieved near wind speed in light conditions. In heavier conditions, speeds in the high teens were effortlessly achieved and an excess of 25 knots under sail is a realistic goal to set. With a cruising speed under power of 14 knots and having attained 20 knots with a minimal following sea with virtually no wake, she is very efficient motoring and has a true global range. For a cruising catamaran, these performance figures are unheard of.



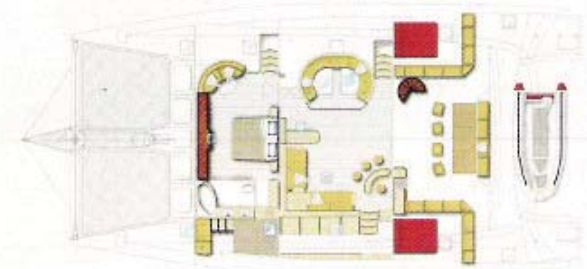

Her 38-foot beam gives stability second to none, providing a tranquil ride. All sailing is carried out with ease from the large fly bridge that is accessed from the aft deck via an artfully sculptured stainless steel stairway. The fly bridge is equipped with the latest in navigational equipment, complemented with comfortable all round seating which frames an elegant Jacuzzi and wet bar.

The Silhouette 760 has an intuitive rig and push button sail design with self tacking jib and fully battened in-boom hydraulic furling system. This allows a minimal crew requirement to handle a sailing yacht of this size.

When entering the yacht via large swept transoms with tender docks on either side, you'll be astounded by the sheer size and intelligent management of space. The aft deck provides alfresco dining for 12, and large sliding doors lead into the salon giving a true sense of spaciousness and uninterrupted flow. The salon is laid out with a formal dining area, lounge and bar that can be accessed from both the salon and aft deck via a large sliding window, and a double door fridge. Centralized is the navigation station where all systems are at hand, including a state of the art entertainment unit with a 42" Plasma TV which rises from a hidden bulkhead.



www.seafaring.com



The Silhouette 760 offers the amenities and spacious living quarters usually associated with the world's best hotels. She has four very large en suite guest cabins with walk around queen sized beds, large frameless glass showers and silent push button toilets. Each has the latest in entertainment with large 19" plasma screens, play stations, DVD players, voice & DSL satellite communications and unusually large port lights for an abundance of natural light.

The master cabin is full beam width with a king sized bed, large walk-in closet and en suite head with a spacious shower and exquisite spa bath, complemented with exotic Italian marble flooring. Caribbean sunsets or Mediterranean vistas could definitely be enjoyed while lying in bed gazing out of the large forward facing windows. Add to all this the latest in surround sound and entertainment systems, and you may never want to leave the cabin.

The port side of the yacht has a vast galley that both chefs and food lover's alike will appreciate. Large modern stainless steel fridge and freezers, vast areas of work space and the latest in Italian stove, oven and hob ensure the very best of culinary delights.

This truly is a one-of-a-kind catamaran that has questioned the conventions of yacht design. Hull number two is under construction and scheduled for launch soon. Can such refined elegance get any better than this? For more information you can go to the Matrix website at www.matrix-yachts.com, then go buy those lottery tickets. ♪

Silhouette 760

LOA:	78.8 feet
Beam:	38 feet
Draft:	5 feet
Displacement: (loaded)	40,000 kg
Power:	two Yanmar 240 hp diesels
Fuel:	526 gal.
Water:	790 gal.

Latitudes & Attitudes 49